

M12 Thread L= 25 mm

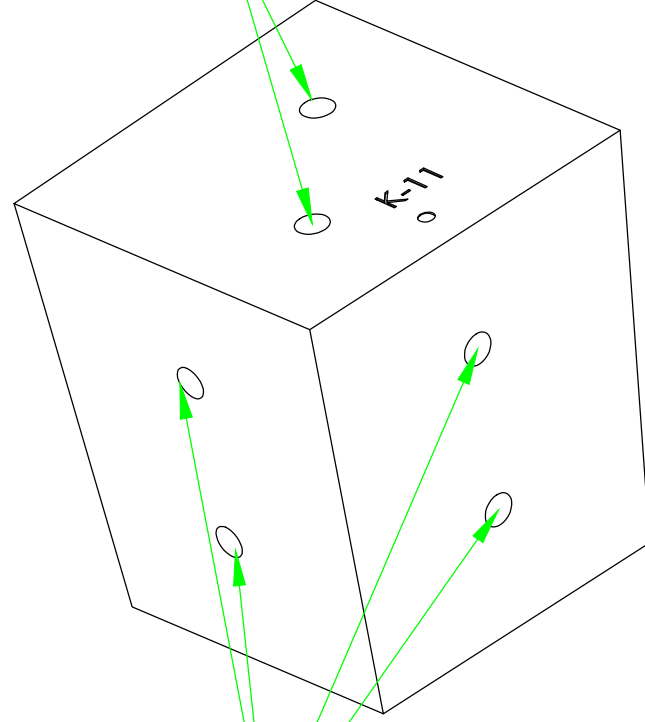

M12 Thread L = 25 mm

VIEW A

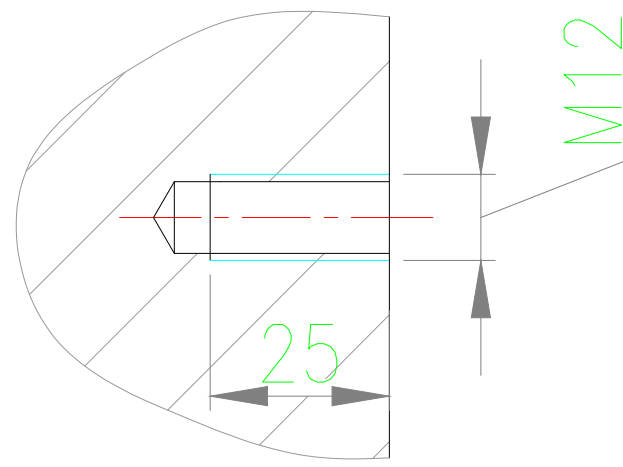

M12 Detail Scale:2/1
M12 Thread L= 25 mm

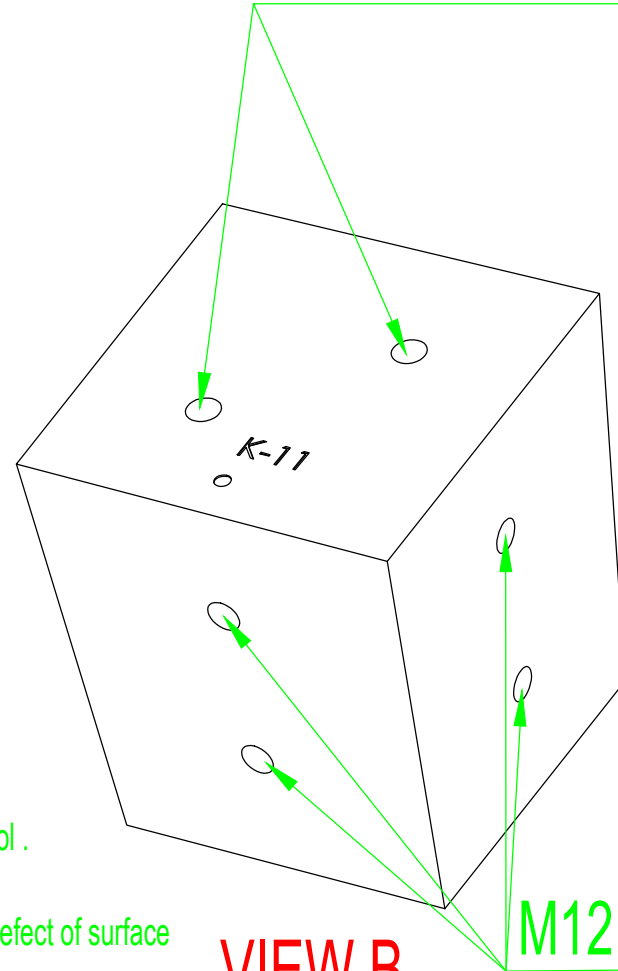

VIEW B

M12 Thread L = 25 mm

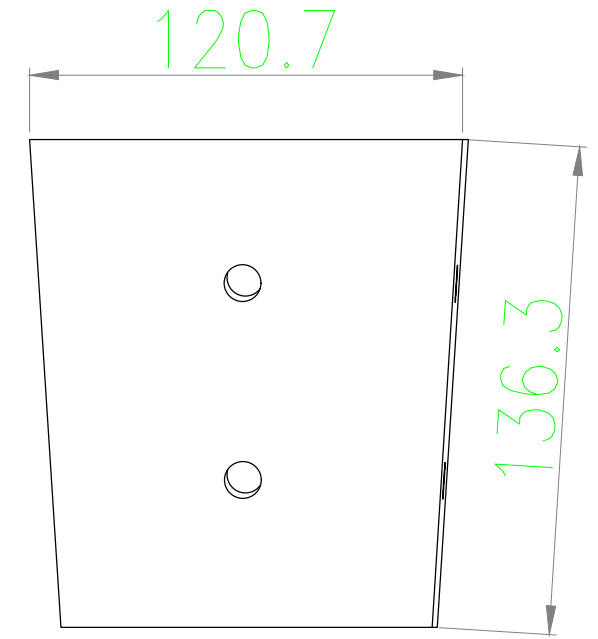

VIEW C

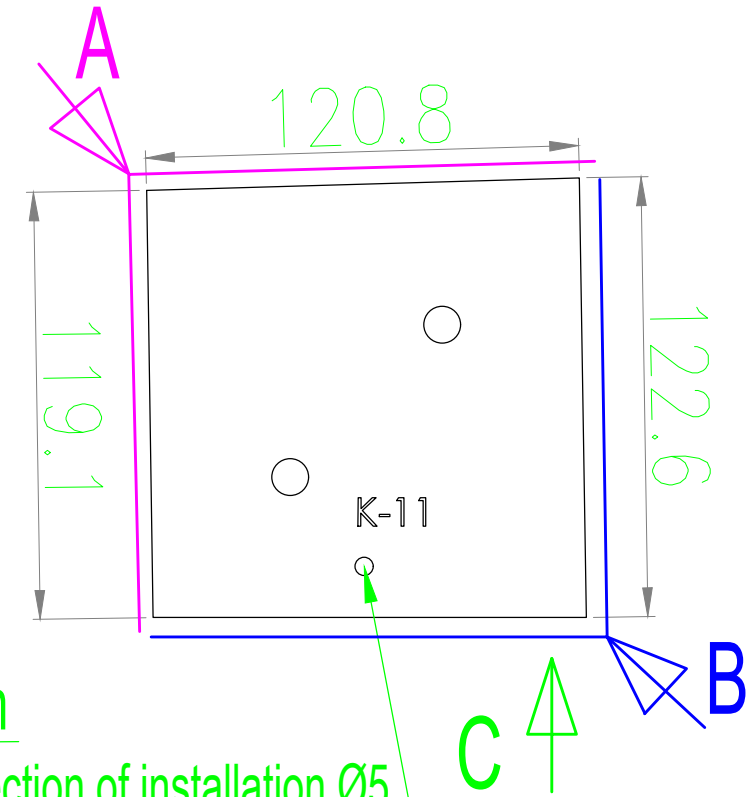

Direction of installation Ø5
(Applications point, this
created accidentally)

12.5

LINEAR DIMENSIONS:

Permissible deviations in mm for ranges in nominal lengths	f (fine)	Tolerance class designation (description)		v (very coarse)
		m (medium)	c (coarse)	
0.5 up to 3	±0.05	±0.1	±0.2	-
over 3 up to 6	±0.05	±0.1	±0.3	±0.5
over 6 up to 30	±0.1	±0.2	±0.5	±1.0
over 30 up to 120	±0.15	±0.3	±0.8	±1.5
over 120 up to 400	±0.2	±0.5	±1.2	±2.5
over 400 up to 1000	±0.3	±0.8	±2.0	±4.0
over 1000 up to 2000	±0.5	±1.2	±3.0	±6.0
over 2000 up to 4000	-	±2.0	±4.0	±8.0

2 PIECES

PROJECT NAME:
POLONYA GR-7

DRAWING NAME:

K-11

PROJECT CODE: 947 APPROVED:M.CAGLAN DRAWING BY:K. ARSLAN

DATE: 27/11/2018

FORM
A3

SCALE:

MetalYapi Eng &Const.
ENG Metal Yapi İnşaat Taahhüt San. Dış Tic. A.Ş.
Ruzgarlibahçe Mah. Plaza K Is Merkezi Kat: 5 34813
Kavacik / Beykoz / ISTANBUL
Tel: +90 216 425 03 25 Faks: +90 216 425 03 20
e-posta: metalyapi@metalyapi.com www.metalyapi.com

F.04.06 REV.NO: C SUBAT 2010